

800.622.11 (Shank 1/2") - ASSEMBLY FOR DOUBLE ROUND OVER R3mm ADJUSTABLE WITH BALL BEARING GUIDE

900.622.11 (Shank 12mm) - ASSEMBLY FOR DOUBLE ROUND OVER R3mm ADJUSTABLE WITH BALL BEARING GUIDE

ROUND OVER - Cutting Height (H)

Assembly sequence n°	11.1mm 7/16"	12.7mm 1/2"	15.87mm 5/8"	19.05mm 3/4"	22.2mm 7/8"	1" 25,4mm	28.5mm 1-1/8"	30.1mm 1-3/16"	31.75mm 1-1/4"
	WITHOUT BEARING			WITH BEARING					
15		990.020.00	990.020.00	-	990.020.00	-	990.020.00	-	990.020.00
14	990.020.00	541.500.00	541.517.00	990.020.00	541.515.00	990.020.00	541.518.00	990.020.00	541.517.00
13	541.517.00	541.500.00	541.500.00	541.517.00	541.515.00	541.518.00	541.518.00	541.516.00	541.518.00
12	541.500.00	541.501.00	541.500.00	541.501.00	541.518.00	541.518.00	541.501.00	541.500.00	541.501.00
11	541.501.00	791.037.00	791.037.00	541.501.00	541.501.00	541.501.00	541.500.00	541.501.00	822.031.11
10	541.501.00	541.519.00	541.519.00	541.501.00	541.501.00	541.519.00	822.031.11	822.031.11	541.515.00
9	791.037.00	822.031.11	822.031.11	541.519.00	541.519.00	822.031.11	541.515.00	541.516.00	541.515.00
8	541.519.00	541.515.00	541.515.00	822.031.11	822.031.11	541.515.00	541.515.00	541.518.00	541.518.00
7	822.031.11	541.515.00	541.516.00	541.518.00	541.515.00	541.516.00	541.517.00	541.518.00	541.518.00
6	541.515.00	541.517.00	541.517.00	541.518.00	541.515.00	541.501.00	541.519.00	541.519.00	541.519.00
5	541.517.00	541.518.00	541.518.00	791.037.00	541.500.00	791.037.00	791.037.00	791.037.00	791.037.00
4	541.517.00	541.518.00	541.501.00	541.518.00	791.037.00	541.500.00	541.500.00	541.500.00	541.519.00
3	541.501.00	541.501.00	541.501.00	541.518.00	541.501.00	541.500.00	541.501.00	541.501.00	541.500.00
2	822.032.11	822.032.11	822.032.11	822.032.11	822.032.11	822.032.11	822.032.11	822.032.11	822.032.11
1	8/924.137.00	8/924.137.00	8/924.137.00	8/924.137.00	8/924.137.00	8/924.137.00	8/924.137.00	824.137.00	8/924.137.00

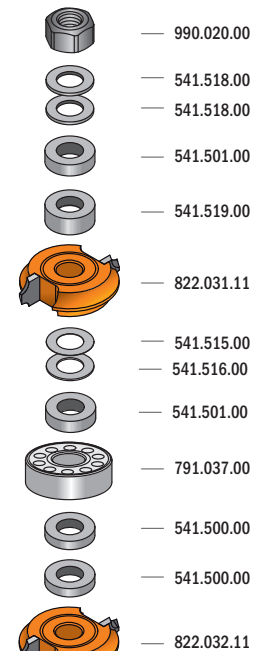

03.60.0307 - page 1/2

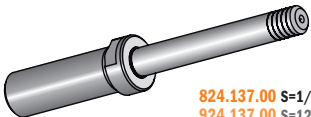

824.137.00 S=1/2"
924.137.00 S=12mm

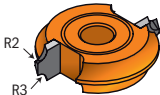

822.031.11
R2mm R5/64"
R3mm R1/8"



791.037.00
Ø8-28mm - H9mm

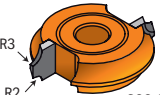

822.032.11
R3mm R1/8"
R2mm R5/64"



541.515.00
0,0039" - 0,1mm



541.516.00
0,0118" - 0,3mm



541.517.00
0,0196" - 0,5mm



541.518.00
0,039" - 1,0mm



541.500.00
0,118" - 3,0mm



541.501.00
0,157" - 4,0mm



541.519.00
0,228" - 5,8mm



990.020.00
M8

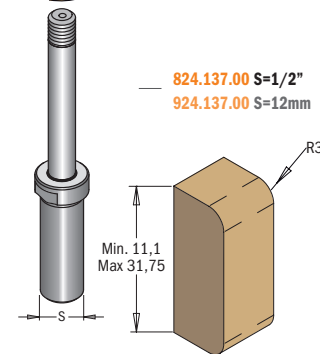

800.622.11 (Shank 1/2") - ASSEMBLY FOR DOUBLE "ROUNDROVER R2mm ADJUSTABLE WITH BALL BEARING GUIDE

900.622.11 (Shank 12mm) - ASSEMBLY FOR DOUBLE "ROUNDROVER R2mm ADJUSTABLE WITH BALL BEARING GUIDE

ROUNDROVER - Cutting Height (H)

Assembly sequence n°	7/16"	1/2"	5/8"	3/4"	7/8"	1"	1-1/8"	1-3/16"	1-1/4"
	11,1mm	12,7mm	15,87mm	19,05mm	22mm	25,4mm	28,5mm	30,1mm	31,75mm
	WITHOUT BEARING			WITH BEARING					
15	-	-	-	-	-	-	-	-	-
14	990.020.00	990.020.00	990.020.00	990.020.00	990.020.00	990.020.00	990.020.00	990.020.00	990.020.00
13	541.516.00	541.517.00	541.517.00	541.517.00	541.516.00	541.518.00	541.500.00	541.517.00	541.516.00
12	541.518.00	541.500.00	541.501.00	541.501.00	541.500.00	541.500.00	541.501.00	541.517.00	541.516.00
11	541.518.00	541.501.00	791.037.00	541.519.00	541.501.00	541.519.00	822.032.11	541.518.00	541.500.00
10	541.500.00	791.037.00	541.519.00	541.519.00	541.519.00	822.032.11	541.515.00	541.500.00	822.032.11
9	541.501.00	541.519.00	822.032.11	822.032.11	822.032.11	541.515.00	541.516.00	822.032.11	541.515.00
8	791.037.00	822.032.11	541.517.00	541.517.00	541.515.00	541.516.00	541.516.00	541.516.00	541.515.00
7	541.519.00	541.516.00	541.516.00	541.517.00	541.515.00	541.516.00	541.518.00	541.500.00	541.500.00
6	822.032.11	541.516.00	541.515.00	541.518.00	541.501.00	541.501.00	541.519.00	541.501.00	541.519.00
5	541.515.00	541.515.00	541.500.00	541.518.00	791.037.00	791.037.00	791.037.00	791.037.00	791.037.00
4	541.500.00	541.501.00	541.501.00	791.037.00	541.518.00	541.500.00	541.501.00	541.519.00	541.519.00
3	541.501.00	541.501.00	541.501.00	541.500.00	541.501.00	541.501.00	541.501.00	541.501.00	541.501.00
2	822.031.11	822.031.11	822.031.11	822.031.11	822.031.11	822.031.11	822.031.11	822.031.11	822.031.11
1	8/924.137.00	8/924.137.00	8/924.137.00	8/924.137.00	8/924.137.00	8/924.137.00	8/924.137.00	8/924.137.00	8/924.137.00

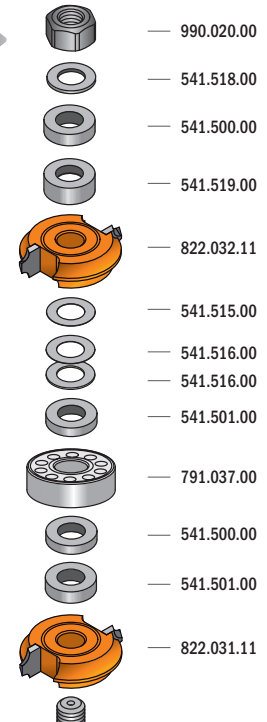

03.60.0307 - page 2/2

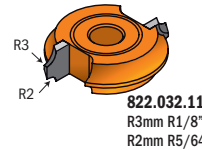
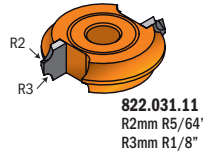
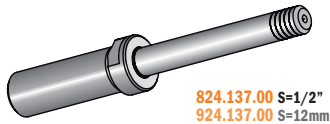

541.515.00
0,0039" - 0,1mm



541.516.00
0,0118" - 0,3mm



541.517.00
0,0196" - 0,5mm



541.518.00
0,039" - 1,0mm



541.500.00
0,118" - 3,0mm



541.501.00
0,157" - 4,0mm



541.519.00
0,228" - 5,8mm



990.020.00
M8

